

CMPD3003
 CMPD3003A
 CMPD3003C
 CMPD3003S

**SURFACE MOUNT
 LOW LEAKAGE
 SILICON SWITCHING DIODE**

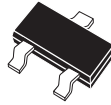

SOT-23 CASE

CentralTM
Semiconductor Corp.

DESCRIPTION:

The CENTRAL SEMICONDUCTOR CMPD3003 series types are silicon switching diodes manufactured by the epitaxial planar process, designed for switching applications requiring an extremely low leakage diode.

The following configurations are available:

CMPD3003	SINGLE
CMPD3003A	DUAL, COMMON ANODE
CMPD3003C	DUAL, COMMON CATHODE
CMPD3003S	DUAL, IN SERIES

MARKING CODE: LLO
MARKING CODE: LLA
MARKING CODE: LLC
MARKING CODE: LLS

MAXIMUM RATINGS: (T_A=25°C)

	SYMBOL		UNITS
Continuous Reverse Voltage	V _R	180	V
Average Rectified Current	I _O	200	mA
DC Forward Current	I _F	600	mA
Peak Repetitive Forward Current	I _{FRM}	700	mA
Peak Forward Surge Current, tp=1 μs	I _{FSM}	2.0	A
Peak Forward Surge Current, tp=1 s	I _{FSM}	1.0	A
Power Dissipation	P _D	350	mW
Operating and Storage			
Junction Temperature	T _J , T _{stg}	-65 to +150	°C
Thermal Resistance	θ _{JA}	357	°C/W

ELECTRICAL CHARACTERISTICS PER DIODE: (T_A=25°C unless otherwise noted)

SYMBOL	TEST CONDITIONS	MIN	MAX	UNITS
BV _R	I _R =5.0μA	200		V
I _R	V _R =125V		1.0	nA
I _R	V _R =125V, T _A =150°C		3.0	μA
I _R	V _R =180V		10	nA
I _R	V _R =180V, T _A =150°C		5.0	μA
V _F	I _F =1.0mA	0.62	0.72	V
V _F	I _F =10mA	0.72	0.83	V
V _F	I _F =50mA	0.80	0.89	V
V _F	I _F =100mA	0.83	0.93	V
V _F	I _F =200mA	0.87	1.10	V
V _F	I _F =300mA	0.90	1.15	V
C _T	V _R =0, f=1 MHz		4.0	pF

SOT-23 CASE - MECHANICAL OUTLINE

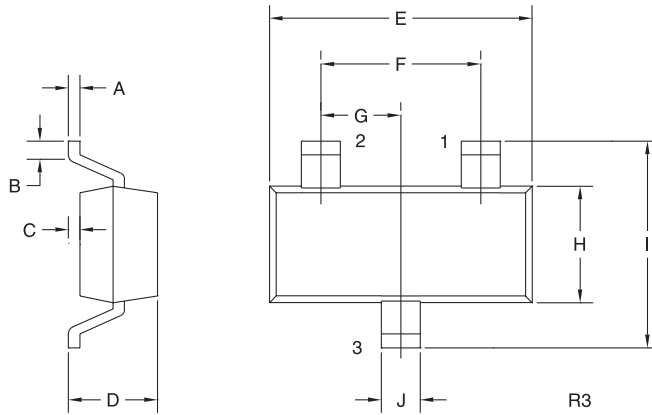

SYMBOL	DIMENSIONS			
	INCHES		MILLIMETERS	
	MIN	MAX	MIN	MAX
A	0.003	0.007	0.08	0.18
B	0.006	-	0.15	-
C	-	0.005	-	0.13
D	0.035	0.043	0.89	1.09
E	0.110	0.120	2.80	3.05
F	0.075		1.90	
G	0.037		0.95	
H	0.047	0.055	1.19	1.40
I	0.083	0.098	2.10	2.49
J	0.014	0.020	0.35	0.50

SOT-23 (REV: R3)

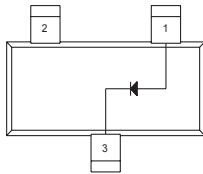

LEAD CODE:
CMPD3003
1) Anode
2) No Connection
3) Cathode
MARKING CODE: LLO

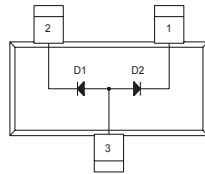

LEAD CODE:
CMPD3003A
1) Cathode D2
2) Cathode D1
3) Anode D1, Anode D2
MARKING CODE: LLA

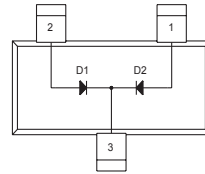

LEAD CODE:
CMPD3003C
1) Anode D2
2) Anode D1
3) Cathode D1, Cathode D2
MARKING CODE: LLC

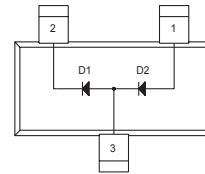

LEAD CODE:
CMPD3003S
1) Anode D2
2) Cathode D1
3) Anode D1, Cathode D2
MARKING CODE: LLS

R3 (6-August 2003)